

The **MOVEMENT JOINT** has been specially created to relieve the stress in prestige floors (marble, granite, ceramic tiles or wood) laid on a mortar bed. The joint is simply inserted by hand and is levelled with a plastic hammer. It is available in brass and stainless steel with internal vulcanised expanded EPDM gasket. Strong, practical and top quality. Lay the joints according with the standards in force.

MORTAR-LAID JOINTS

POLISHED BRASS - STAINLESS STEEL AISI304/1.4301-V2A WITH SANDABLE VULCANIZED EPDM



POLISHED BRASS WITH SANDABLE VULCANIZED EPDM
bar length 2 lm - pack: 25 Pcs - 50 lm (GOT 20... - 20 lm)

Article	L x H mm
GOT 20...	10 X 20
GOT 40...	10 X 40

On demand, delivery time to be agreed



POLISHED STAINLESS STEEL AISI 304/1.4301-V2A WITH SANDABLE VULCANIZED EPDM
bar length 2 lm - pack: 25 Pcs - 50 lm (GAC 20... - 40 lm)

Article	L x H mm
GAC 20...	10 X 20
GAC 40...	10 X 40

GOT/AC 20...

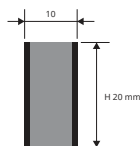

GOT/AC 40...

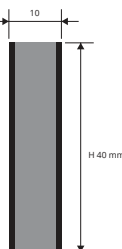

movement joints

SUITABLE FOR USE IN CONTACT WITH FOODSTUFFS

COLOURS

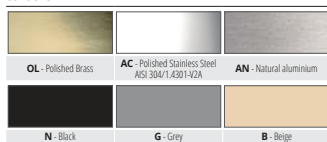

ON DEMAND MINIMUM QUANTITY 500 LM PER COLOUR AND HEIGHT



(price and delivery time to be agreed)

NATURAL ALUMINIUM WITH SANDABLE VULCANIZED EPDM
bar length 2 lm - pack: 25 Pcs - 50 lm (GAL 20... - 40 lm)

Article	L x H mm
GAL 20...	10 X 20
GAL 40...	10 X 40

Insert available in the colours: G - N - B (White, Ivory and Brown available on demand with a minimum quantity order of 500 lm). The code of the selected finish must be added to the article code. E.g.: GAC 20... (chosen insert colour grey) GAC 20G.

EXAMPLES AND INSTRUCTIONS FOR LAYING METHODS

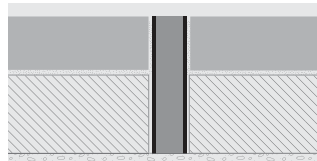

1. Choose the colour and the necessary height of the joint, calculating the thickness of the finished floor and the thickness of the screed.
2. Insert the joint into the screed letting it protrude slightly.
3. Proceed with laying the floor, aligning it with the rigid vertical part of the joint.
4. Complete laying by levelling the joint with the rigid part with the floor.
5. Using the mortar, grout the gap between the tiles and the profile.

This **DOUBLE SILICONE JOINT** is a co-extruded profile in hard and soft PVC. The double internal silicone provides a high degree of resistance to any type of compressive stress, heavy loads and foot traffic. The extension is designed to lengthen the joint, extending it to the total depth of auxiliary or insulation castings as required. Lay the joints according with the standards in force.

MORTAR-LAID DOUBLE JOINT

VINYL RESIN CO-EXTRUSION (PVC)



CO-EXTRUDED VINYL RESIN (PVC) WITH DOUBLE SILICONE
bar length 2,5 lm - pack: 40 Pcs - 100 lm (GDSP 43 - CONF. 50 lm)

Article	L x H mm
GDSP 43...	10 X 43
GDS 23...	10 X 23
GP 20...	8 X 20

ARTICLES NOT FOR SALE SINGLE

Available combinations: GS - GT - GL.
The code of the selected colour must be added to the article code.
E.g.: GDSP 43... (combination chosen colour dark grey/transparent)
GDSP 43GT.



COLOURS



GDSP 43...



GDS 23...

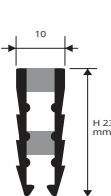

GP 20

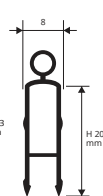

movement joints

EXAMPLES AND INSTRUCTIONS FOR LAYING METHODS

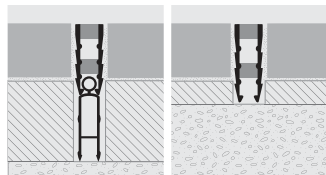

1. Choose the colour and the necessary height of the joint, calculating the thickness of the finished floor and the thickness of the screed.
2. Insert the joint into the screed letting it protrude slightly.
3. Proceed with laying the floor, aligning it with the rigid vertical part of the joint.
4. Complete laying by levelling the joint with the floor.
5. Using the mortar, grout the gap between the tiles and the profile.